



Slade End, Epping, CM16

BUTLER  STAG





Located in the heart of the picturesque and highly sought-after village of Theydon Bois, this delightful three-bedroom home offers an excellent opportunity for those seeking village charm with superb transport links. Just a one-minute walk from Theydon Bois Underground Station (Central Line), the property is ideally positioned for commuters and families alike.



## Freehold

- End Of Terraced Family Home
- Three Bedrooms
- Spacious Kitchen
- Central Village Location
- South West Facing Garden
- Single Garage/Parking

Arranged over two floors, the accommodation comprises a welcoming entrance hall with guest cloakroom, a well-proportioned kitchen, and a spacious living room that opens directly onto the rear garden – perfect for relaxing or entertaining. Upstairs, you'll find three bedrooms and a family bathroom. While the property would benefit from some cosmetic updating, it offers fantastic potential to create a stylish and comfortable family home.

Slade End is a desirable address within Theydon Bois, a village known for its community feel, central green with duck pond, and a range of local amenities including shops, pubs, and restaurants. The surrounding area boasts beautiful countryside with Epping Forest on the doorstep, along with a choice of excellent state and private schools. Leisure facilities are also well catered for, with golf courses, sports centres, and a tennis club all nearby.

This is a rare opportunity to secure a home in one of the most charming and convenient locations in the area.







## Slade End

Approx. Gross Internal Area 74.3 Sq M ( 800 Sq Ft )

BUTLER & STAG

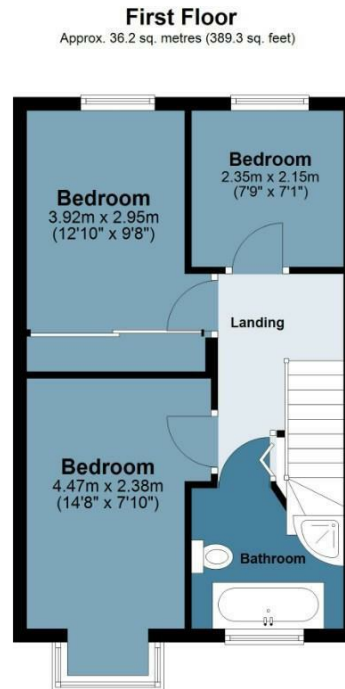
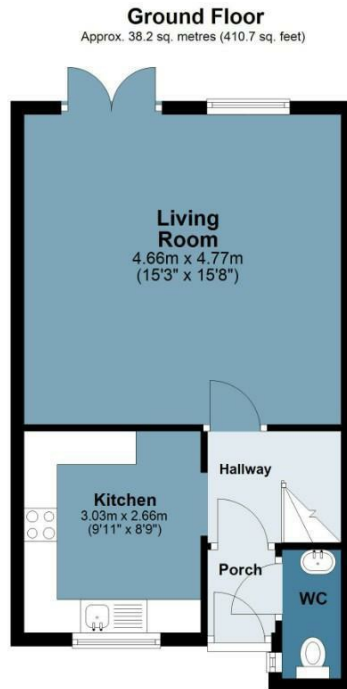

Measurements are approximate and for illustration purposes only. While we do not doubt the accuracy and completeness, we advise you conduct a careful independent assessment of the property to determine monetary value.  
© @modephoto.uk www.modephoto.co.uk

IMPORTANT NOTICE - These particulars have been prepared in good faith and they are not intended to constitute part of an offer or contract. We have not performed a structural survey on this property and the services, appliances and specific fittings have not been tested. All photographs, measurements, floor plans and distances referred to are given as a guide and should not be relied upon.

BUTLER & STAG

☎ 01992 667666

🏠 4 Forest Drive, Theydon Bois, Essex, CM16 7EY

✉ theydon@butlerandstag.com

[www.butlerandstag.uk](http://www.butlerandstag.uk)